

Distributed by



Web Site: [www.quickbeton.com](http://www.quickbeton.com)

Web Site: [www.boviar.com](http://www.boviar.com)

The calibrated form in plastic for packaging cubic test pieces in cement mix with side measurement of 150 mm

**USE MANUAL**  
*(follow the red arrows)*

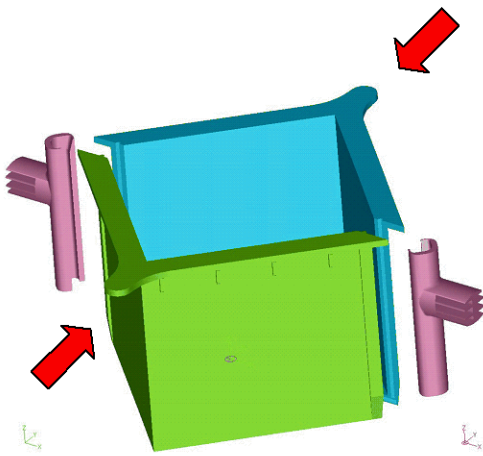

1) Make sure that the different tapped parts of the two form elements are perfectly clean. Bring the two elements close together until the two different tapped parts come into contact.

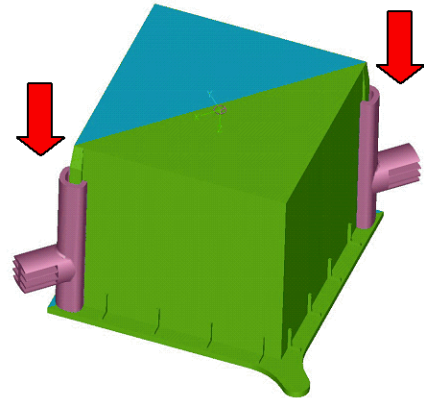

2) Overturn the form and lay it on the work top, tighten the two elements (differently tapped) inserting the two side inserts in the closing guides, by sliding them downward.

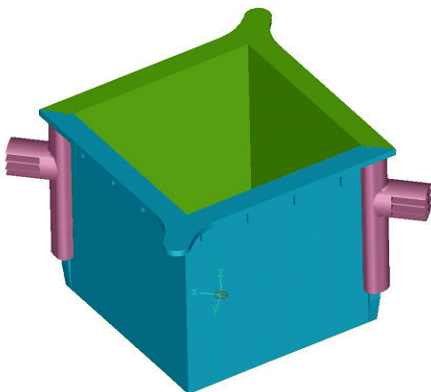

3) Next, package the test piece with a jet of cement mix, following the instructions specified in UNI EN 12390-2:2002.

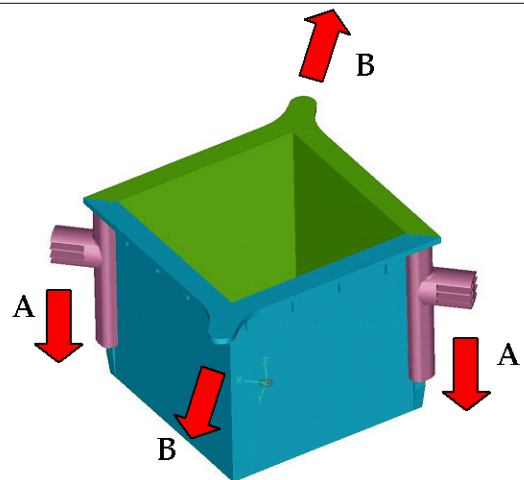

4) 72 hours after packaging, de-form the concrete test piece, withdrawing the two side closing inserts (A), by sliding them downward. Remove the two elements (B) and extract the test piece.



*Made in Italy*

The plastic form that:

- cuts down installation time to a minimum;
- lets you work in a wholly safe, precise way;
- is just right for packaging and easy de-forming (without risks of any damage) of cubic test pieces with 150 mm side.

**Respects the dimensional tolerances specified in UNI EN 12390-1:2002 (Hardened concrete test. Shape, dimensions and other requirements for test pieces and forms).**

It consists of two identical elements that are easy to assemble as they are supplied with an appropriate tapped part. The elements are coupled by the fastening of two side closing inserts.

A plastic thwacker is part of the standard supply.

Note: **The mix in the form should be tamped with the thwacker 27 times, until it flows back, in three layers, following a spiral-route starting from the outer edge.**

The thwacker should be used to remove excess mix from the form's jet face, after the tamping operations, with an alternating saw type movement, in order to level the face surface.

The advantages are quite clear:

- no form assembly **errors** by the operator;
- cuts down use and maintenance **time** and **costs**;
- can be **reused** (up to 15 times);
- **lightweight** (about one kilo);
- completely **recyclable** in terms of ecology;
- **perfect test surfaces** without using any means of form removal;
- **unmistakable marking of the test piece**, according to the mandatory provisions of Italian Ministerial Decree of 09.01.1996 Annex. 2 of point 5.3 and as prescribed by UNI EN 12390-2:2002 point 5.4.1.

In fact, "**Quick beton**" enables you to customize the marking when the test piece is being packaged. This is how it's done: a removable data-insert is fitted on the face opposite to the jet. The following data can be cut on this insert: concrete producer's name, the rubber stamp of the Works Manager, reference to a given job-order, and, if necessary, the jet date, etc.

- considerably cuts in **packing, transport** and **storage costs** (a 6-piece package measures 300 mm x 400 mm x 200 mm).

**Warnings:**

- ❖ Product use temperature : +10 °C to + 40 °C;  
Clean the form after use, using water only.